

13 1/2" MAX. BOLT CIRCLE FOR 1 1/4" DIA. BOLTS
 10 1/2" MIN. BOLT CIRCLE FOR 1" DIA. BOLTS

7/8" THK. (TYP.)
 4 1/16" REF.
 5 1/2"
 10 1/2" B.C.

1/4"-20NC-2 HEX NUT - 2 REQUIRED
 ROUND HEAD MACHINE SCREW
 1/4"-20NC-2 X 1 1/2" LONG
 #AS-1283

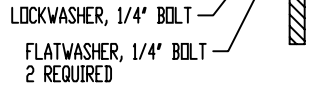

ELECTRICAL GROUNDING DETAIL
 (ALL HARDWARE STAINLESS STEEL - PASSIVATED)

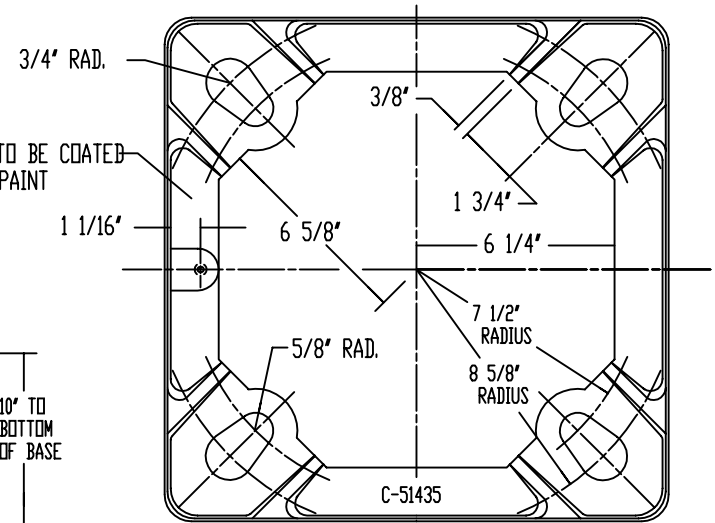

BOTTOM OF BASE TO BE COATED WITH BITUMINOUS PAINT

C-51435

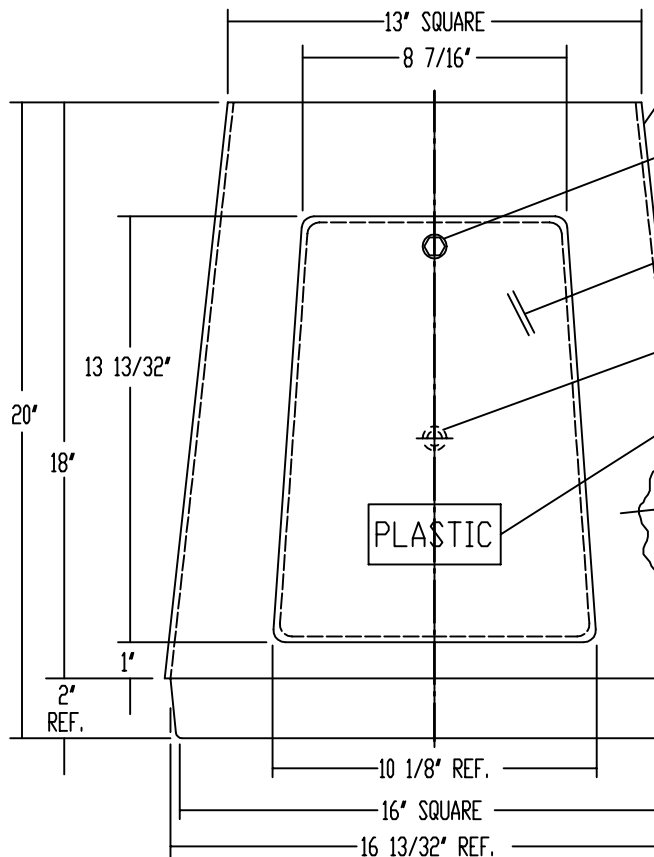

TOP CASTING TB-2A #C-80290
 356-T6 AL. ALLOY
 1/4"-20NC-2 X 1" LG. ST. STL. HEX SOCKET BUTTON HEAD SCREW

1/4" THK. ABS PLASTIC DOOR ASSEMBLY WITH ULTRA-VIOLET INHIBITORS
 ELECTRICAL GROUNDING SCREW SEE GROUNDING DETAIL
 2" X 3" SELF-ADHESIVE LABEL FIXED TO OUTSIDE SURFACE OF DOOR

3/16" THK. (TYP.)

SEE DETAIL "A"

BOTTOM CASTING TB-2A #C-51435
 356-T6 AL. ALLOY

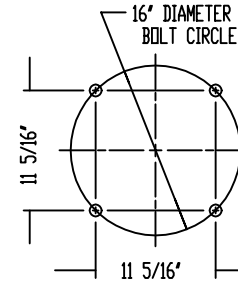

1"-8NC-2 X 3" LONG HEX HEAD BOLT, LOCKWASHER AND FLATWASHER - H.R.S. - GALV. (4 OF EACH REQUIRED)

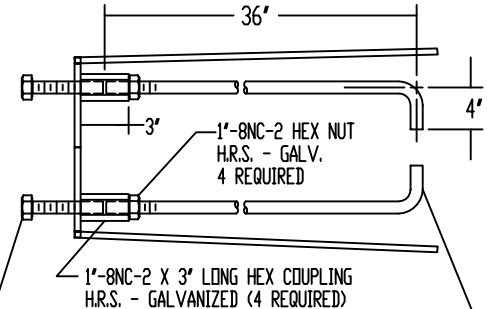

1" DIA. X 40" LONG ANCHOR ROD (4 REQUIRED). ANCHOR ROD TO BE 55,000 PSI MIN. YIELD STRENGTH PER AASHTO M314-90, GRADE 55. TOP 12" OF ROD TO BE GALVANIZED PER AASHTO M232 CLASS C, (ASTM A 153).

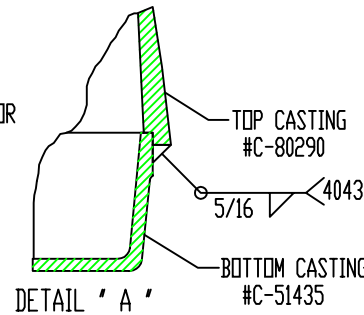

DETAIL "A"

P&K

<table border="1"> <tr> <th>ALT.</th> <th>DESCRIPTION</th> <th>DATE</th> <th>BY</th> <th>CR.</th> </tr> <tr> <td> </td> <td> </td> <td> </td> <td> </td> <td> </td> </tr> </table>				ALT.	DESCRIPTION	DATE	BY	CR.						<table border="1"> <tr> <td> <table border="1"> <tr> <td>DR.</td> <td>M.M.S.</td> <td>03-17-94</td> <td>INC. NO.</td> </tr> <tr> <td>CH.</td> <td>V.W.V.</td> <td>03-17-94</td> <td></td> </tr> <tr> <td>APP.</td> <td></td> <td></td> <td></td> </tr> <tr> <td>SCALE</td> <td colspan="3">NONE</td> </tr> </table> </td> <td> <table border="1"> <tr> <td colspan="2">P&K POLE PRODUCTS, INC. 84 Foundry St., Newark, N.J.</td> </tr> <tr> <td colspan="2">TITLE " TB-2A/BERGEN "</td> </tr> <tr> <td colspan="2">BERGEN CODE TB-10</td> </tr> <tr> <td colspan="2">C-95632-1</td> </tr> </table> </td> </tr> <tr> <td colspan="4"> CUSTOMER: BERGEN COUNTY DEPT. OF PUBLIC WORKS </td> <td colspan="2"> PROJECT: </td> </tr> </table>		<table border="1"> <tr> <td>DR.</td> <td>M.M.S.</td> <td>03-17-94</td> <td>INC. NO.</td> </tr> <tr> <td>CH.</td> <td>V.W.V.</td> <td>03-17-94</td> <td></td> </tr> <tr> <td>APP.</td> <td></td> <td></td> <td></td> </tr> <tr> <td>SCALE</td> <td colspan="3">NONE</td> </tr> </table>	DR.	M.M.S.	03-17-94	INC. NO.	CH.	V.W.V.	03-17-94		APP.				SCALE	NONE			<table border="1"> <tr> <td colspan="2">P&K POLE PRODUCTS, INC. 84 Foundry St., Newark, N.J.</td> </tr> <tr> <td colspan="2">TITLE " TB-2A/BERGEN "</td> </tr> <tr> <td colspan="2">BERGEN CODE TB-10</td> </tr> <tr> <td colspan="2">C-95632-1</td> </tr> </table>	P&K POLE PRODUCTS, INC. 84 Foundry St., Newark, N.J.		TITLE " TB-2A/BERGEN "		BERGEN CODE TB-10		C-95632-1		CUSTOMER: BERGEN COUNTY DEPT. OF PUBLIC WORKS				PROJECT:	
ALT.	DESCRIPTION	DATE	BY	CR.																																											
<table border="1"> <tr> <td>DR.</td> <td>M.M.S.</td> <td>03-17-94</td> <td>INC. NO.</td> </tr> <tr> <td>CH.</td> <td>V.W.V.</td> <td>03-17-94</td> <td></td> </tr> <tr> <td>APP.</td> <td></td> <td></td> <td></td> </tr> <tr> <td>SCALE</td> <td colspan="3">NONE</td> </tr> </table>	DR.	M.M.S.	03-17-94	INC. NO.	CH.	V.W.V.	03-17-94		APP.				SCALE	NONE			<table border="1"> <tr> <td colspan="2">P&K POLE PRODUCTS, INC. 84 Foundry St., Newark, N.J.</td> </tr> <tr> <td colspan="2">TITLE " TB-2A/BERGEN "</td> </tr> <tr> <td colspan="2">BERGEN CODE TB-10</td> </tr> <tr> <td colspan="2">C-95632-1</td> </tr> </table>	P&K POLE PRODUCTS, INC. 84 Foundry St., Newark, N.J.		TITLE " TB-2A/BERGEN "		BERGEN CODE TB-10		C-95632-1																							
DR.	M.M.S.	03-17-94	INC. NO.																																												
CH.	V.W.V.	03-17-94																																													
APP.																																															
SCALE	NONE																																														
P&K POLE PRODUCTS, INC. 84 Foundry St., Newark, N.J.																																															
TITLE " TB-2A/BERGEN "																																															
BERGEN CODE TB-10																																															
C-95632-1																																															
CUSTOMER: BERGEN COUNTY DEPT. OF PUBLIC WORKS				PROJECT:																																											